

# WM Programmable Shower Sensor

## AC10-035

The WM Programmable Shower sensor. 316 Stainless Steel. Adjustable settings include; run-on time, sensor range, purge and more.

### PRODUCT NUMBER

AC010-035

### TECHNICAL DATA

Material	316 Stainless Steel
Surface finish	Gold Brushed
Gross weight	0.2 kg
Operation type	A.I.R (Active Infrared) touch-free
Type of mounting	Wall mounted ( $\varnothing 27\text{mm}$ drill hole required)
Adjustable settings	
Runtime	30 Seconds, 1, 2, 3, 4 & 5 Minutes (Default 1 Minute)
Sensor range	1-3 (Default 2)
Wave-on / Wave-off operation	ON/OFF (Default OFF)
Anti Vandal time	Run +10s
Automatic purge	ON/OFF, 3, 6, 12, 24, 36, 48 Hours (Default OFF)
Purge run time	30 secs, 1, 2, 4 & 8 mins (Default 1 Minute)
Lock outs	OFF, 4, 6, 8 & 10 ops (Default OFF)

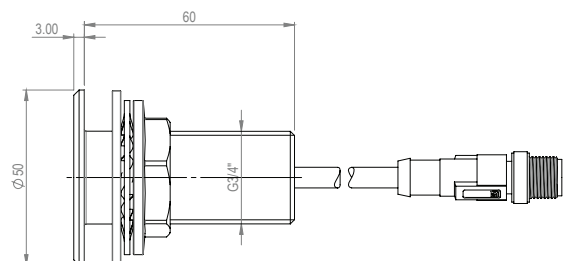
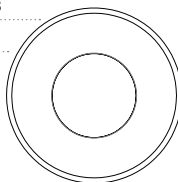

Last updated:  
2021-11-05, Dart Valley Systems