

Deck mounted mixer with levers

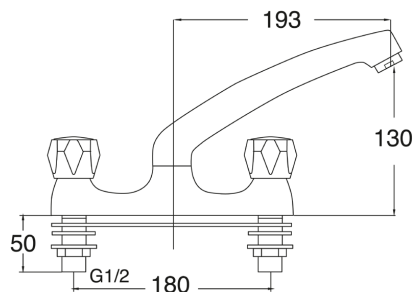

F1331N

Deck mounted mixer with levers

Deck mounted mixer tap for connecting to hot and cold water. Supplied with 150mm long levers which can be operated with a closed fist or wrists using a quarter turn action. The swivel spout allows water to flow into both bowls when fitted centrally between sink bowls. Manufactured from chromium plated brass. Conforms to BS5412 standard.

Technical data

Calculation flow rate cold water	0.2 litre per second
Calculation flow rate hot water	0.2 litre per second
Gross weight	1.98kg
Diameter nominal	DN 10
Minimum flow pressure	0.2 bar
Type of mixing	With mixer
Overall depth	150mm
Overall height	155mm
Overall width	300mm
Sound insulation	No
Spout projection	150mm
Surface material	Chrome
Type of fitting	Lever mixer
Volume flow rate at 3 bar	0.2 litre per second
Net weight	1.8kg