

Plaster sink, right-hand drainer

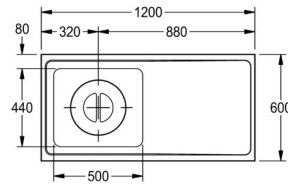
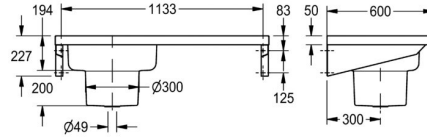

G22000RN

Plater sink, right-hand drainer

Plaster sink top manufactured from 1.2mm thick grade 1.4301 (304) stainless steel, with a satin polish finish, the bowl is made from 1.5mm material. Available in 1200 length the single bowl incorporates a plaster catcher sump which is prepared for a 38mm waste. A flush grated waste is available as an extra. A plaster catcher/basket and lid is supplied which fits into the sump in order to prevent loose plaster from entering the waste and causing a blockage.

Technical data

Bowl - bowl depth	400mm
Bowl depth	500mm
Bowl width	400mm
Gross weight	22.5kg
Material	Stainless steel
Material code	1.4301 chrome nickel steel V2A
Material thickness	1.2mm
Net weight	21.1kg
Overall depth	600mm
Overall width	1,200mm
Sump depth	200mm
Surface finish	Satin finish
Type of mounting	Wall mounting
Waste size	DN 32

No tapholes are provided so any taps to be fitted must be wall mounted. Stainless steel cantilevered brackets and stainless steel front leg supports can be supplied as an extra. Both these types of supports rely on a strong wall fixing, particular when the brackets are fitted. No wall fixing are supplied. L or R after the code number refers to the handing of the drainer ie. left or right when facing the unit.