

KWC
Cleaners sink

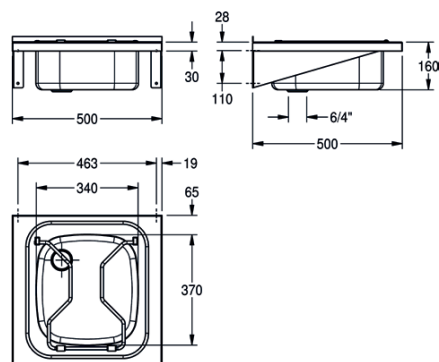

WB500GV

Cleaners sink

General purpose sink for wall mounting, stainless steel, surface satin finished, material thickness 1.5mm, seamless welded bowl with dimensions 370x340x160mm, rounded edges, 1 1/2" plug waste with plastic overflow pipe, drainage back left, 30mm rear upstand, incl. stainless steel grid with rubber bumps, incl. stainless steel screws and dowels.

Technical data

Bowl position	Center
Bowl construction	Radius corners
Bowl - bowl depth	160mm
Bowl depth	370mm
Bowl width	340mm
Drainer or storage	No
Grid	Hinged
Grid material	Stainless steel
Gross weight	6.5kg
Material	Stainless steel
Material code	1.4301 chrome nickel steel
Material code grid	1.4301 chrome nickel steel
Material thickness	1.5mm
Net weight	5.3kg
Outlet size	G 1 1/2 B
Overall depth	500mm
Overall height	180mm
Overall width	500mm
Overflow	Standpipe overflow
Rear upstand	No
Splash back	Optional
Surface / bowl finish	Satin finish
Tap ledge	No
Type of mounting	Wall mounting
Waste hole projection	150mm
Waste size	DN 40
Waste kit included	Yes
Type of waste kit	Standpipe strainer
Splash back height	20mm