

KWC

Security coat hook

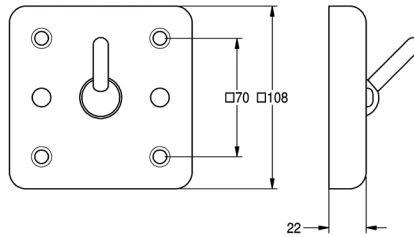

HDTX692

Security coat hook

Coat hook, stainless steel, material thickness 2 mm, visible surface satin finished. Safety hook tilts downwards when overloaded, projection 30 mm from wall plate. Dimensions 108 x 108 x 52 mm (W x H x D). Mounting from the front.

Technical data

Gross weight	0.5kg
Number of hooks	1
Material	Stainless steel
Material code	1.4301 chrome nickel steel V2A
Material thickness	2mm
Net weight	0.48kg
Overall depth	52mm
Overall height	108mm
Overall width	108mm
Special functionality	Ligature-resistant feature
Surface finish	Satin finish
Type of fixing	Screw
Type of mounting	Wall mounting