

KWC
Wave-on sensor

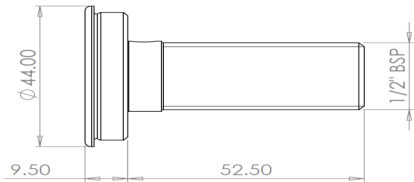

VR00-080
Wave-on sensor

Wave-on sensor for bath filling module with cold insert. Stainless Steel. Brushed finish, complete with 15m cable length.

Technical data

Material	Stainless steel
Surface finish	Brushed
Gross weight	0.4kg
Thread diameter	Ø21mm
Type of mounting	Onto Bath Filling Module (VR01-111 ONLY)
Operation type	A.I.R (Active Infrared) touch free
Cable length	15m
Adjustable settings	Dictated by control box used