

# STANDARD SHOWER SENSOR

With 15m Cable

**SH00-004**

Wave-on sensor c/w 45mm bezel for shower towers. Stainless Steel. Complete with 15m cable length.

---

## PRODUCT NUMBER

SH00-004

---

## TECHNICAL DATA

Material	Stainless Steel
Surface finish	Machined
Gross weight	0.23 kg
Overall dimensions	38mm (L) x Ø45mm
Thread diameter	½" BSP
Type of mounting	Wall mounted (Ø22mm drill hole required)
Operation type	A.I.R (Active Infrared) touch-free
Cable length	15 m
Adjustable settings	Dictated by control box used

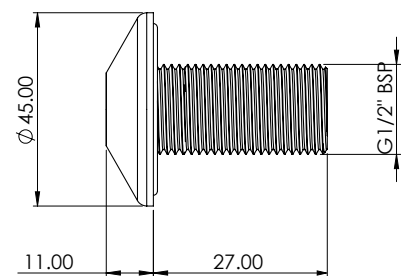
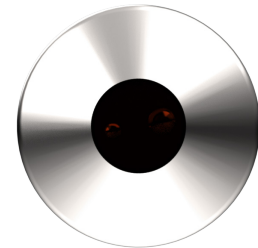

ALL DIMENSIONS IN MM

Last updated:  
2021-10-06, Dart Valley Systems