

# ELECTRONIC PILLAR MIXER

F5EM1001 | 2030027923

PRODUCT GROUP (PG) : Taps | ARTICLE FAMILY (AF) : Electronic tap | ARTICLE GROUP (AG) : F5EM1001 ++ | LIFECYCLE : New | MODEL RANGE : F5

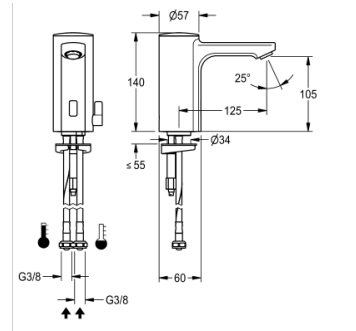

F5E-Mix pillar mixer DN 15 for sanitary facilities, opto-electronically controlled. For connection to hot and cold water via hoses with integrated backflow preventer and strainers. Control electronics, solenoid valve cartridge, 6 V lithium battery (CR-P2) and sensor in all-metal housing, high-polished chromium-plated brass. Temperature lever with adjustable, turn-proof temperature stop as well as conversion set for concealed mixing device. Anti-theft aerator, design SLIM, with integrated flow regulator 5.0 l/min. Activated water hygiene flushing 24 hours after last activation, safety switch-off with continuous reflection and saving of statistical data. With option for parameterization and communication via optional, bidirectional remote control.

## TECHNICAL DATA

Gross Weight	4.04 kg
Net Weight	3.90 kg
Functional Principle	ELECTRONIX-C
Type Of Mixing	YES
Type Of Mounting	TAPHOLE
Type Of Tap	PILLAR-TAB
Calculation Flow Rate Cold Water	0.07 liter per seconds
Calculation Flow Rate Hot Water	0.07 liter per seconds
Default Automatic Hygiene Flushing	24H-AFTER-ACTIVITY
Depressurised	NO
Diameter Nominal	DN-15-1-2INH
Material Fitting	BRASS
Minimum Flow Pressure	1.00 bar
Power Supply Connection	BATTERY-6-V
Protective Shutdown	YES
Spout Projection	125.00 mm
Surface Finish Fitting	CHROMISED
Type Of Operation	SENSOR-OPERATION
Type Of Sensor	OPTO-ELEC-SENSOR
Volume Flow Rate At 3 Bar	0.08 liter per seconds
Protective System Ip	59K
Thermal Disinfection	NO
Inlet Size	G3-8
Sound Insulation	NO

# ELECTRONIC PILLAR MIXER

F5EM1001 | 2030027923

PRODUCT GROUP (PG) : Taps | ARTICLE FAMILY (AF) : Electronic tap | ARTICLE GROUP (AG) : F5EM1001 ++ | LIFECYCLE : New | MODEL RANGE : F5

## ACCESSORIES

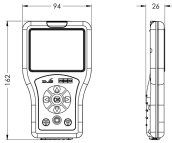

REMOTE CONTROL

2030036654

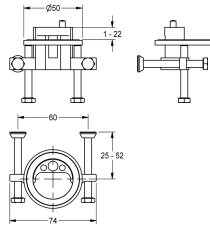

TWIST-PROOF SET

2030035383

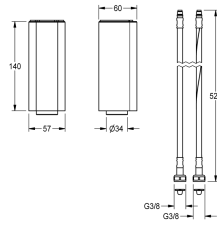

SOCKET

2030040334

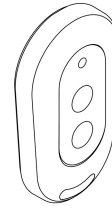

REMOTE CONTROL

2030036849

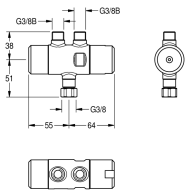

THERMOSTATIC MIXING VALVE

2030012758

## SPARE PARTS

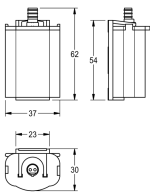

BATTERY COMPARTMENT

2000109466

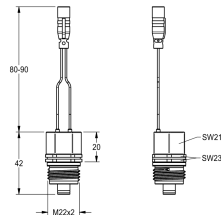

SOLENOID VALVE CARTRIDGE

2030003033