

# NON CONCUSSIVE TAP

## MT00-030

The basin mounted push tap is designed for use with our range of thermostatic mixing valves. With a simple, non concussive operation and water saving technology this tap is ideal for use in areas such as leisure and commercial washrooms. The simple operation of the push tap enables users with limited mobility to use the facility.



### PRODUCT NUMBER

MT00-030	Basin Mounted Push Tap
----------	------------------------

### TECHNICAL DATA

Material	Brass
Surface finish	Chromed
Gross weight	0.60kg
Type of operation	Hand (push) operated
Type of mounting	Deck mounted
Spout projection	105mm
Pressure ranges	0.2-10 bar
Fixing	1/2" BSP

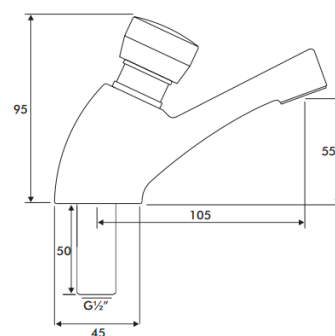

ALL DIMENSIONS IN MM

Last Updated: 2018-08-21, Dart Valley Systems

