

KWC

Jumbo roll holder for wall mounting

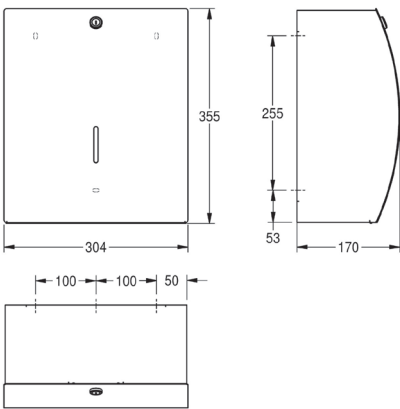

STR670

Jumbo roll holder

STRATOS jumbo toilet roll holder for wall mounting, stainless steel, surface satin finished, material thickness 1.5mm, closed casing with curved front and inspection window, paper dispenser with two serrated tear-off edges, cylinder lock with key, for one large roll with maximum diameter 295 mm and maximum depth 105 mm, including mounting material.

Dimensions 304 x 355 x 170 mm (Wx H x D)

Technical data

Max depth/diameter of consumables	295mm
Max width of consumables	105mm
Filling quantity	1
Filling quantity uom	Rolls
Lock	Key lock
Material	Stainless steel
Material code	1.4301 chrome nickel steel V2A
Material thickness	1.5mm
Overall depth	170mm
Overall height	355mm
Overall width	304mm
Spindle	Yes
Type of fixing	Screw
Type of mounting	Wall mounting