

RODAN toilet brush holder

Model line: RODAN | **RODX687**

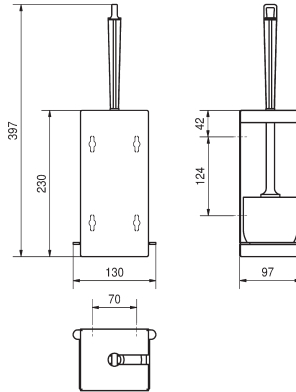

RODX687

Toilet roll holder

Toilet brush holder for wall mounting, stainless steel, surface satin finished, material thickness 1.2 mm, folded front, closed cover to the front, with white nylon brush with flushing rim cleaner, withdrawal opening either left or right, depending on mounting, removable plastic drip tray, includes stainless steel screws and dowels.
Dimensions 107 x 230 x 97 mm (W x H x D)

Technical data

Brush colour	White
Material	Stainless steel
Material code	1.4301 chrome nickel steel V2A
Material thickness	0.8mm
Overall depth	97mm
Overall height	230mm
Overall width	107mm
Surface finish	Satin finish
Tailor made	No
Type of brush	Nylon
Type of fixing	Screw
Type of mounting	Wall mounted