

HIGH SECURITY BTW WC PAN

WITH L/H & R/H INFILL

VR01-046

High Security WC Pan with double infill; water efficient 4 litre flush, domestic aesthetic, moulded impact resistant construction, vandal and ligature resistant, suitable for mental healthcare, healthcare and custodial applications.



PRODUCT NUMBER

VR01-046

TECHNICAL DATA

Material	High Performance Composite material
Gross weight	33.3 kg
Overall dimensions	510mm (d) x 800mm (w) x 420mm (h)
Type of mounting	Thru wall 4 x 12mm Stainless Steel allthread studding (incl.)
Flush inlet	Ø 55mm
Waste outlet	Ø 100mm
Single flush volume	4 L
Additional features	Hygienic non-porous surface Concealed rear waste outlet Large trap to reduce blockages Warm to the touch surface, eliminates 'icy shock' Fixing kit for walls up to 150mm thick provided, optional kits available

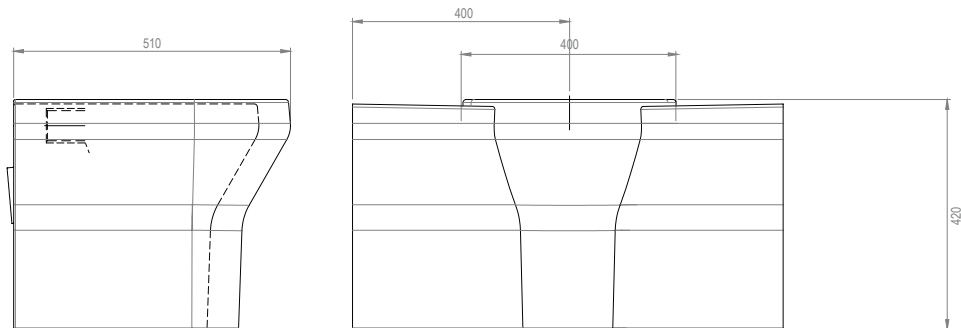
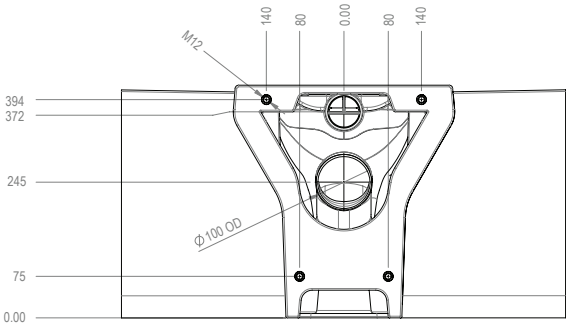

ALL DIMENSIONS IN MM



Last updated:
2019-04-11, Dart Valley Systems

