

## KWC

### Flushmatic downlighter kit for suspended ceilings in white

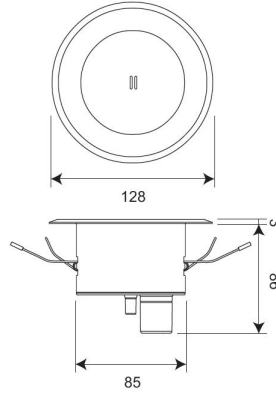

#### UC01-018

Flushmatic downlighter kit - battery

The Flushmatic urinal control is used for multiple station urinals and can be surface or ceiling mounted. This works by using a passive infrared (PIR) detector which detects movement within the sensing area, switching the unit into a timing mode. After a pre-set time, the solenoid valve opens allowing water to flow into the cistern activating the flushing cycle.

#### Technical data

Material	ABS
Gross weight	0.63kg
Type of mounting	Ceiling mounted
Power source	Battery
Voltage	6V
Valve voltage	6V DC
Valve power	6W latching
Operation type	Passive infrared sensor
Current	30 - 40ua standby