

AIR BREAK FOR DIRECT FLUSHING

UC00-001

Prevents backflow to Water Supply.
Chrome plated DZR brass, suitable for urinal bowl applications.

PRODUCT NUMBER

UC00-001 Air Break For Direct Flushing

TECHNICAL DATA

| | |
|------------------------------|-------------------------|
| Surface finish fitting | Chrome plated DZR brass |
| Back flow prevention | Yes |
| Type | DC |
| Inlet | 15mm |
| Outlet | 22mm |
| Minimum distance from outlet | 1.6m |
| Weight: | 0.55 kg |

ADDITIONAL INFORMATION

Direct flushing for urinal control using potable water supply
To be fitted with a balancing valve
Pipe interrupter
WRAS approved

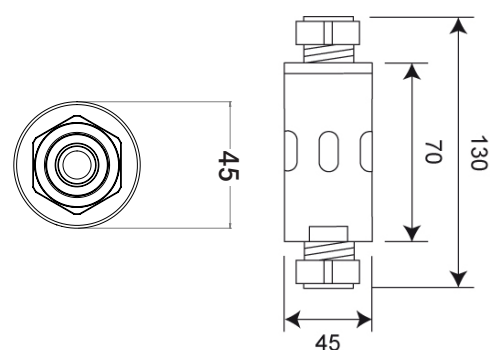

2019-11-15, Dart Valley Systems