

TEMPERATURE BLENDING VALVE ADJUSTER

Model line: SHOWER VALVES



**SH00-011**  
TEMPERATURE BLENDING VALVE ADJUSTER

In many public areas supplying water at 41°C is sufficient. If however, the requirement is to provide 41°C with user adjustment between this temperature and cold (determined by the cold input temperature), The temperature blending valve adjuster can be used to accommodate this facility.

The blender adjuster is Ligature Resistant and Anti-Tamper with Robust Construction whilst retaining an Aesthetically pleasing design.

Technical data		
Material	Body:	Chrome Plated Brass
	Fittings:	DZR Brass
Surface Finish	Chromed Finish	
Weight	0.9 kg	
Wall thickness compatibility	1.5mm - 22mm	
Type of operation	Manual	
Water connection	Brass 1/2" BSP connection	
Recommendations:		
It is strongly recommended to install a thermostatic mixing valve prior to blender valve installation.		

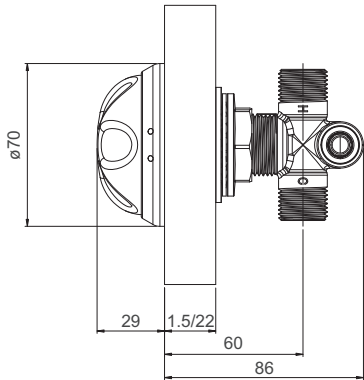

ALL DIMENSIONS IN MM  
UNLESS STATED OTHERWISE