

# AQUARITHERM™

## MT04-001

The Aquaritherm™ designed for use with healthcare environments in mind, with ergonomic easy to clean surfaces.  
7LPM intergrated flow control.  
Single mixed feed connection by Copper tail (10mm). Internal TMV3.  
Chromed finish.

### PRODUCT NUMBER

MT04-001 Manual Aquaritherm

### TECHNICAL DATA

Type of tap	AquariTherm
Material	Brass
Surface finish	Chromed
Gross weight	2.95 kg
Type of operation	Manual operation
Type of mounting	Wall mounted
Type of mixing	Internal TMV3
Spout projection	200mm
Minimum flow pressure	1.00 bar (Lower pressure station kits available)
Volume flow rate at 3 bar	7 LPM
Water connection	10mm Copper tails

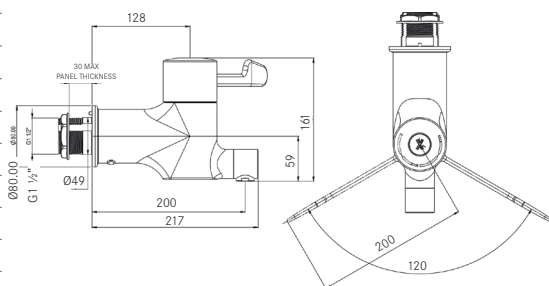

ALL DIMENSIONS IN MM

2015-08-17, Dart Valley Systems

