

## KWC

### Single station mains kit - low pressure

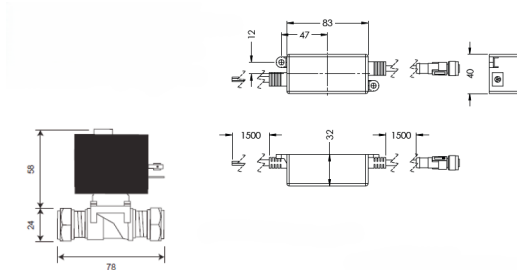
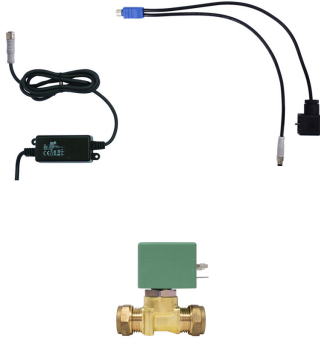

#### AT00-006

Single station mains kit - low pressure

Automatic taps single station mains kit for standard pressure systems (0.5-1 BAR). Kit includes mains PSU and 6V DC Solenoid valve with compression fittings for 15mm pipe, supplied with connecting Y-splitter lead.

#### Technical data

|                           |                           |
|---------------------------|---------------------------|
| Gross weight              | 0.95kg                    |
| <b>Mains PSU</b>          |                           |
| Input                     | 100 - 240v ~ 50/60Hz 0.3A |
| Output                    | 6v 2A                     |
| IP rating                 | 67                        |
| Gross weight              | 0.3kg                     |
| Mains cable length        | 1.5m                      |
| Low voltage cable length  | 1.5m                      |
| <b>Mains PSU</b>          |                           |
| Material                  | ABS / brass               |
| O-ring / washers material | EDPM                      |
| Fitting                   | Ø½" BSP                   |